

STEP 1: WITH ARBOR PRESS, PRESS ITEM# ② INTO GEAR OR USE PRESS FIT LOCKTITE TO HOLD BEARING INTO PLACE.

STEP2: MOUNT BELT GUIDE ITEM# ③ WITH 6-32 SCREW ITEM# ④ .

NOTE: LOCKTITE
AROUND THIS FACE.

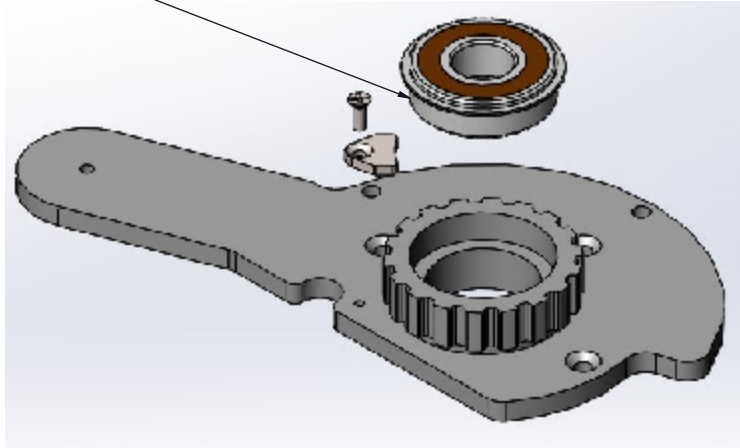

ITEM NO.	PART NUMBER	DESCRIPTION	QTY.
1	DD8-WSA-010	ARM DRIVE GEAR WELDMNT	1
2	6203-2RSNR	ARM MOUNT BEARING	1
3	DD8-107	BELT GUIDE,MAIN ARM	1
4	KFC6C37/Z	6-32 x 3/8 Phillips Flat Head SC	1

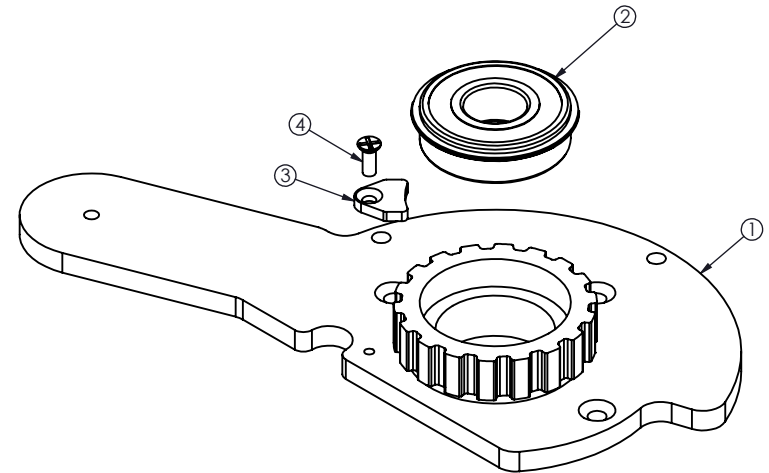

est. 1967 HAMILTON CUSTOM MADE SECURITY	PROPRIETARY AND CONFIDENTIAL THESE DRAWINGS ARE THE PROPERTY OF HAMILTON SAFE CO. AND SHALL NOT BE REPRODUCED, COPIED, USED AS THE BASIS FOR MANUFACTURE OR SALE OF APPARATUS WITHOUT PERMISSION	TITLE	
		ARM DRIVE GEAR ASSEMBLY	
All Weld Notes Comply With AWS A2.4-98 Standards		DRAWN BY dlocul	DATE 10/4/2023
		CHECKED BY	REVISION