

ITEM NO.	PART NUMBER	DESCRIPTION	QTY.
1	90969A370	Shouldber Bolt	1
2	6050K34	OVAL KNOB, MANUAL HANDLE	1
3	H1022/5906K513	Oil-Embedded Thrust Bronze Bearing	2
4	DD8-92	SPACER, MANUAL HANDLE	1
5	91140A261	1074-1095 Spring Steel Shims	1
6	DD8-WSA-008	MANUAL HANDLE WELDMENT	1
7	KSC10F25	10-32 x 1/4" SET SCREW	1
8	DD8-135	ADAPTOR, MOT HANDLE	1
9	H1073	THRUST NEEDLE BEARING	1
10	91263A181	5/16-18 X 3.25 SOC, FT, HD, SC	1
11	91375A776	Alloy Steel Cup-Point Set Screw	1

FOR "MAN" MODEL ONLY.

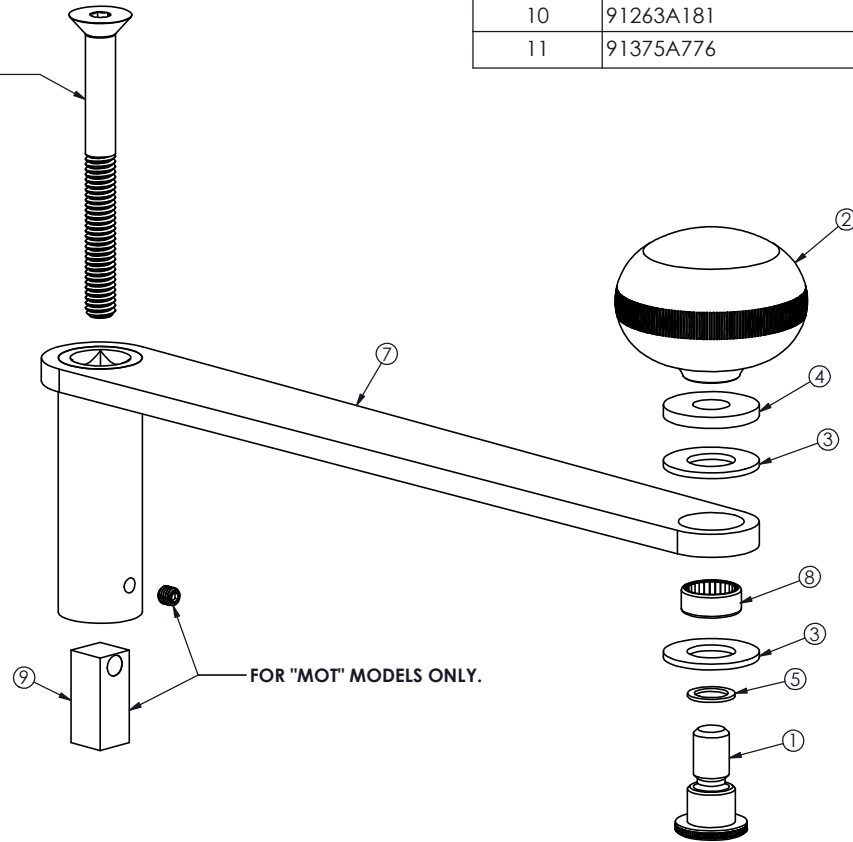

FOR "MOT" MODELS ONLY.

Revision Table			
REV.	DESCRIPTION	DATE	INT.
A	CHANGED ITEMS# 5&9	8/20/24	DC

	<small>PROPRIETARY AND CONFIDENTIAL</small> <small>THESE DRAWINGS ARE THE PROPERTY OF HAMILTON AND SHALL NOT BE REPRODUCED, COPIED, USED AS THE BASIS FOR MANUFACTURE OR SALE OF APPARATUS WITHOUT PERMISSION</small>		<small>TITLE</small> <b>HANDLE ASSEMBLY</b>	
	<small>Part Number</small> <b>DD8-SA-015</b>		<small>FINISH</small> 	
	<small>DRAWN BY</small> <b>DPC</b>	<small>DATE</small> <b>2/9/2021</b>	<small>CHECKED BY</small> 	<small>DATE</small> 
<small>All Weld Notes Comply With AWS A2.4-98 Standards</small>		<small>REVISION</small> <b>A</b>		