

ITEM NO.	PART NUMBER	DESCRIPTION	QTY.
1	DD8-WSA-011	REAR DOOR DRIVER	1
2	DD8-55	REAR DOOR DRIVER AXLE	1
3	H1078	THRUST WASHER	4
4	H1079	THRUST BEARING	2
5	B4634	PRE-LOAD WASHER	1
6	91780A569	5/8 x 3/4 HEX STANDOFF	1
7	6391K623	SLEEVE BUSHING	1
8	FCS25C62/Z	1/4-20 x 5/8 SOC, FT, HD, SC	1
9	91259A175	5/16 x 5/16 Socket Shoulder Screw	1
10	6391K216	Bronze Sleeve Bearing	1
11	H0437	FENDER WASHER	1
12	H1022	Oil-Embedded Thrust Bronze Bearing TT1001	1
13	94831A029	1/4-20 Serrated Flange Locknut (Zinc)	1
14	MXF25C112/Z	1/4-20 x 1-1/8" SOC, FT, HD, SC	1

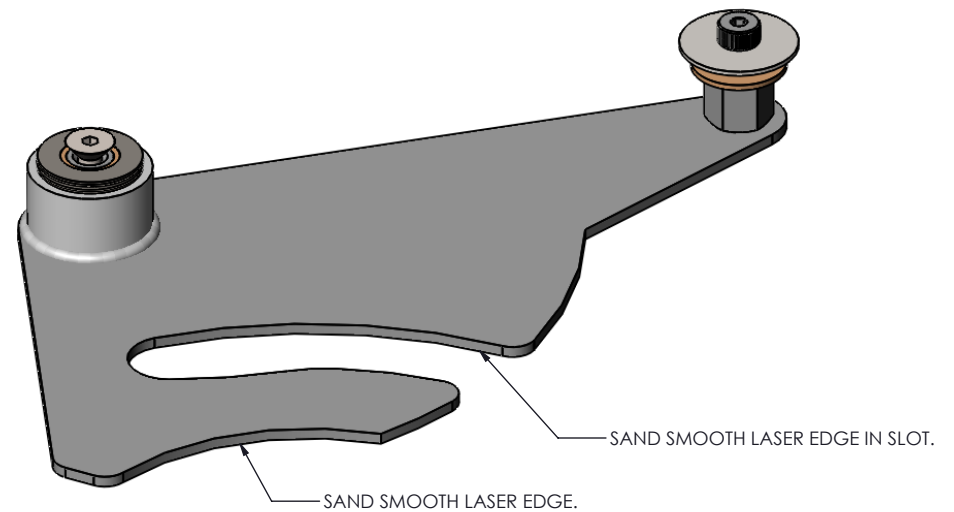

est. 1967 HAMILTON CUSTOM MADE SECURITY	PROPRIETARY AND CONFIDENTIAL THESE DRAWINGS ARE THE PROPERTY OF HAMILTON SAFE CO. AND SHALL NOT BE REPRODUCED, COPIED, USED AS THE BASIS FOR MANUFACTURE OR SALE OF APPARATUS WITHOUT PERMISSION	TITLE REAR DRIVER SUB-ASSEMBLY		
	All Weld Notes Comply With AWS A2.4-98 Standards	PART NUMBER DD8-SA-011	DATE CHECKED BY 2/4/2021	REVISION
DRAWN BY DPC		DATE 2/4/2021	CHECKED BY	REVISION