

ITEM NO.	PART NUMBER	DESCRIPTION	QTY.
1	DD8-42-M	COUNTERTOP-MOTORIZED	1
2	DDMD-28	GUIDE, LATCH RELEASE	1
3	DDMD-29	RELEASE, MOTOR DRIVE	1
4	93330A482	Female Threaded Round Standoff	1
5	9657K333	SPRING, DRAWER LATCH	1
6	MXT8C25/Z	8-32 x 1/4 Phillips Truss MS (SS)	6
7	DDMD-14-B	SWITCH PLATE	1
8	DD8-119	MOUNT, MANUAL SWITCH BRKT	1
9	909	CABLE, RJ-45 JACK PANEL MOUNT TO RJ-45 PLUG, CAT-5E, 300mm LG	1
10	9688K31	Nylon Plastic Snap-in Panel Plugs	2
11	93330A455	Female Threaded Round Standoff	1
12	MX94C50/Z	4-40 x 1/2 Phillips Pan MS (SS)	2
13	DD8-139	Alloy Steel Shoulder Screw	2

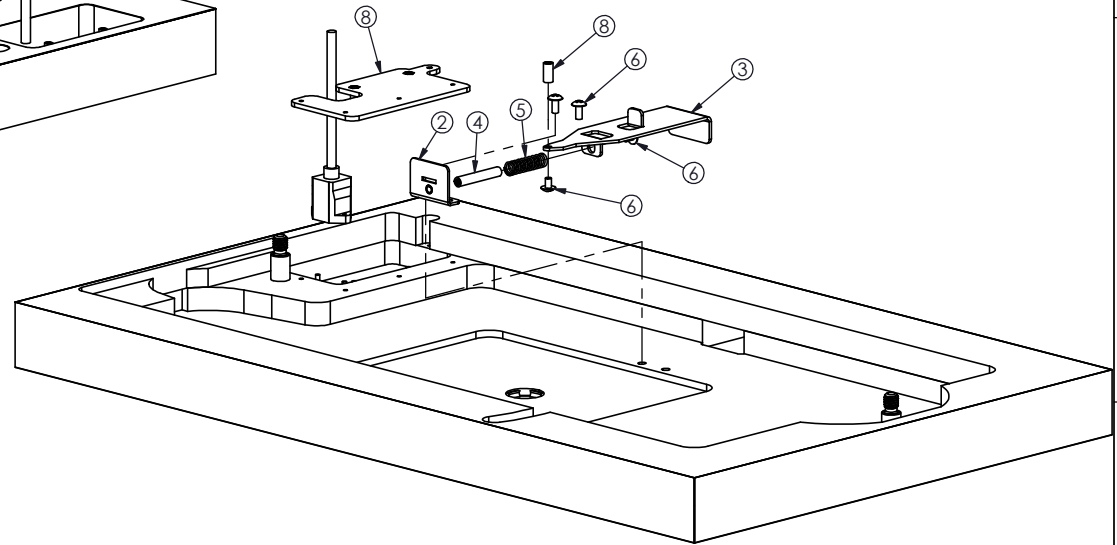
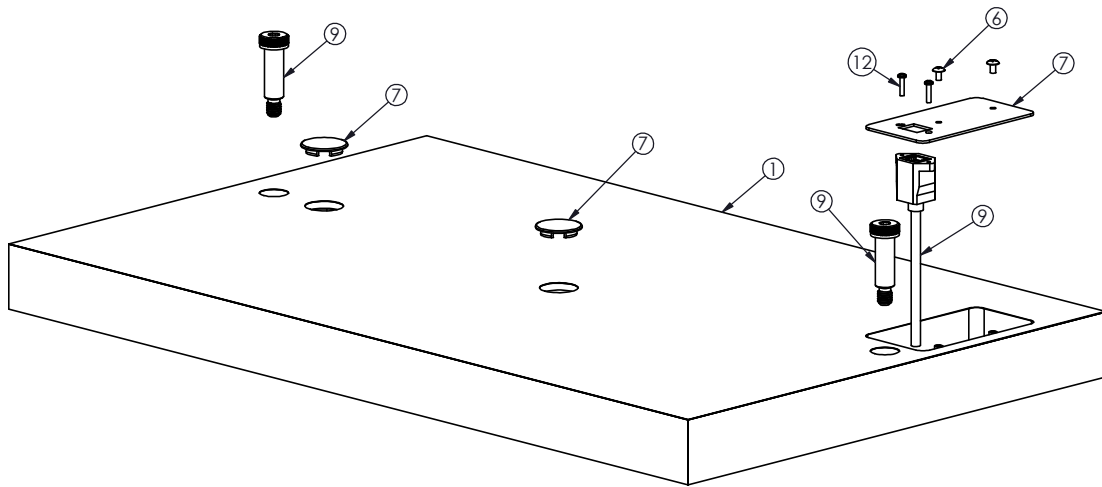

HAMILTON BY GUNNEBO®	PROPRIETARY AND CONFIDENTIAL THESE DRAWINGS ARE THE PROPERTY OF HAMILTON AND SHALL NOT BE REPRODUCED, COPIED, USED AS THE BASIS FOR MANUFACTURE OR SALE OF APPARATUS WITHOUT PERMISSION		TITLE Counter Top, Manual Drawers	
	All Weld Notes Comply With AWS A2.4-98 Standards		PART NUMBER DD8-SA-004-MAN	FINISH
	DRAWN BY diocul	DATE 6/7/2024	CHECKED BY DATE	REVISION