

ITEM NO.	PartNo	DESCRIPTION	QTY.
1	ND21-079	Links, Swing Handle	2
2	B3798	Handle Section, Night Depository	2
3	KSS50R31/S	1/2 x 5/16 Shoulder Screw (SS)	2
4	KBC37C62/S	3/8-16 x 5/8 SBHCS (SS)	2

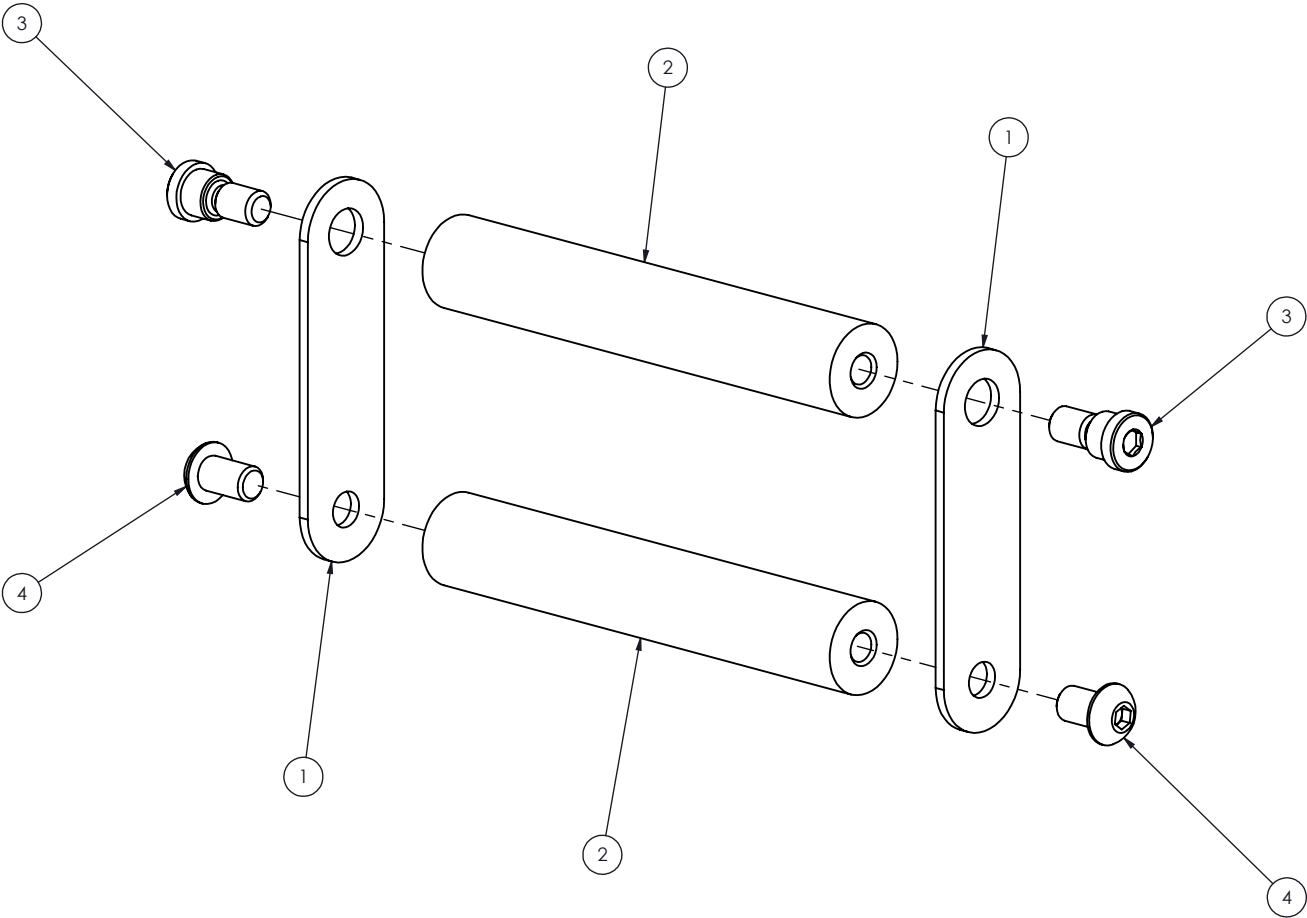

<b>HAMILTON</b> BY <b>GUNNEBO</b>	TITLE		
	Handle Assembly, Oakley Standard		
	PART NUMBER		
	OAK-HNDL-STD		
DRAWN BY	DATE	CHECKED BY	DATE
BlDet	3/7/2025		
REVISION			

ITEM NO.	PartNo	DESCRIPTION	QTY.
1	ND21-199	Handle Links, Extended Length	2
2	B3798	Handle Section, Night Depository	2
3	KSS50R31/S	1/2 x 5/16 Shoulder Screw (SS)	2
4	KBC37C62/S	3/8-16 x 5/8 SBHCS (SS)	2

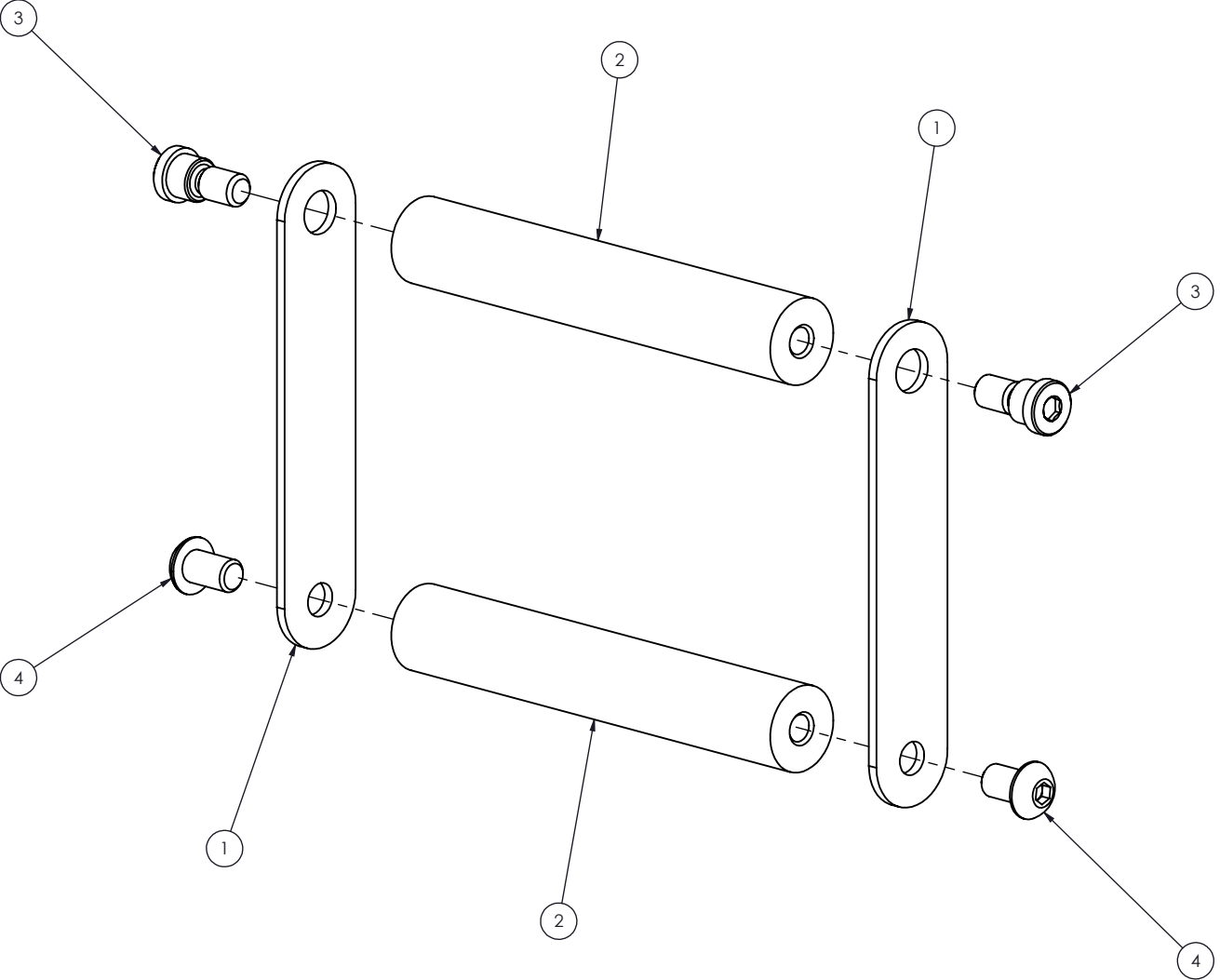

**HAMILTON**  
BY **GUNNEBO**

PROPRIETARY AND CONFIDENTIAL  
THESE DRAWINGS ARE THE PROPERTY  
OF HAMILTON SAFE CO. AND SHALL  
NOT BE REPRODUCED, COPIED, USED  
AS THE BASIS FOR MANUFACTURE OR  
SALE OF APPARATUS WITHOUT  
PERMISSION

TITLE  
Handle Assembly, Oakley Extended Drop

PART NUMBER  
OAK-HNDL-EXT

DRAWN BY  
BilDet

DATE  
3/7/2025

CHECKED BY

DATE

REVISION