

HAMILTON

TECHNICAL BULLETIN

Support Number: 513-874-3733

Fax: 513-874-6232

Web Site: www.hamiltonsafe.com

Email: support@hamiltonsafe.com

Author:
Bill Detherage

Bulletin #
SB-1009

Verification:

Date Issued:
2/9/10

Product:
HA45 & HA50

Date Revised:

Subject:

Water damage to control board in HA45 and HA50 customer units.

To All Dealers,

The newer style HA45 and HA50 customer units with the I/O control boards have been found to be susceptible to water penetration that can affect the electronic control boards. Water on the control boards can cause electrical damage to the board and wire harnesses. Water can possibly be entering into the units through the conduit openings in the top cap of the customer units or by snow blowing through the door opening or around the stainless steel skin.

We have developed a new style control board cover (#B10210) and have outlined a couple areas to seal in an effort to help prevent water damage to the control boards. The new control board covers attach directly to the electronics panel and are formed to fit tight around the panel to help protect the control board from water. We want to try and stop as much water as possible from entering the customer units but also divert any water that does penetrate the unit away from the control board.

The water getting on the control boards may be entering through the conduit openings in the top cap. We recommend the hole plugs or the conduit fittings in the top cap be sealed with a good quality silicone sealant to help prevent water penetration.

The horizontal frame plate right above the electronics panel has two oval shaped openings cut in for wire access from the top. These oval shaped openings should be covered and sealed to prevent water dripping through them onto the control board. We recommend cutting sections from the original plastic control panel cover to glue and seal over these oval shaped openings. If wiring is running through the openings, cover and seal around the wires to prevent water from entering also.

The left rear corner of this same horizontal frame plate should also be sealed to force any water collecting on this frame plate to run forward and to the side down the outside of the new control board cover.

Attached are instructions for the installation and sealing of the HA45 and HA50 customer units. We will be sending the new style control board covers out to the dealers with the affected units. If you need more covers or do not receive them within the next couple of weeks, please call or email to let us know you need part B10210.

If you have any questions about this notice, please contact Bill Detherage with Hamilton Air by phone (513) 874-3733 or email billd@hamiltonsafe.com

2/18/2010

Model **HA-45** and **HA50** with I/O controls.
Modified Control Board Cover.

Reinstall Control Board Cover after unit installation.

This unit must have control board cover B10210 installed to protect control board from possible water damage. Make sure control board cover B10210 is reinstalled after unit is installed.

Cover and seal oval shaped wire openings in frame above control board as shown below. Openings should be factory sealed but if wires are ran though during installation, reseal to prevent water penetration. Make sure unit is sealed along back and side of this frame panel also to stop any water from running down onto the control board below.

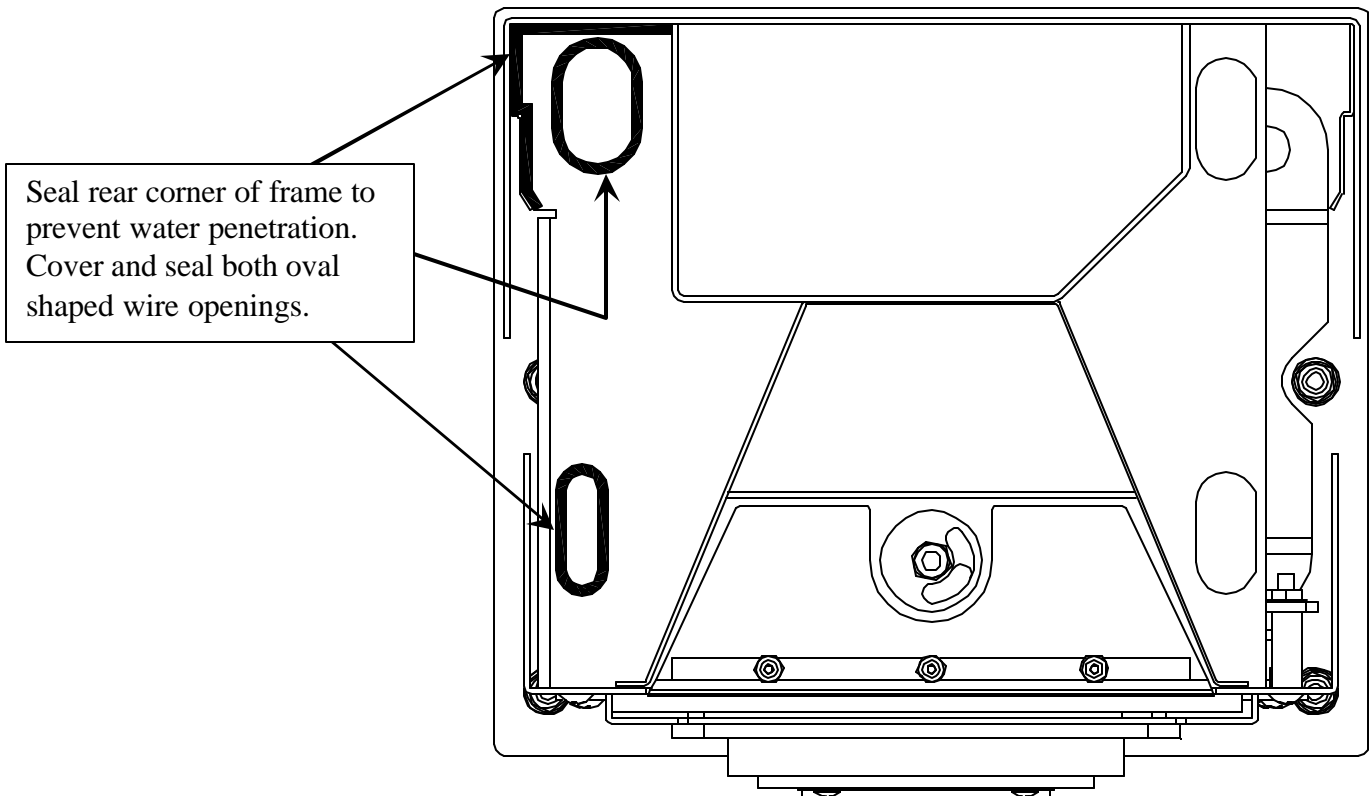
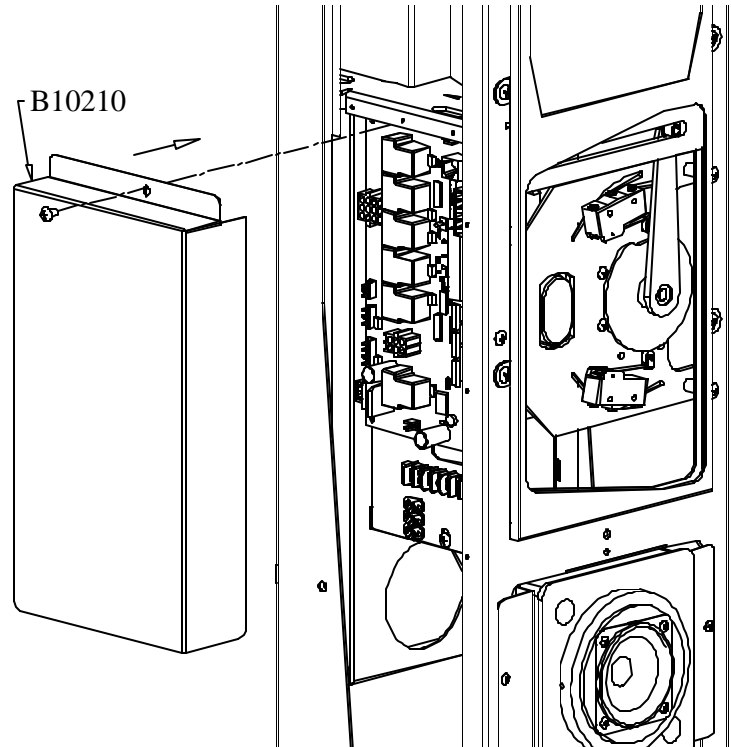

HAMILTON AIR®

3143 Production Drive • Fairfield, Ohio 45014 • 513-874-3733

Model **HA-45** and **HA50**

with I/O controls.

Removable or remote turbine packs.

Modified Control Board Cover Installation Instructions

The new control board cover, part number B10210, is to help protect the electronic board from water inside the HA45 and HA50 customer units with the new style I/O control boards.

Unit identification:

HA45 and HA50 models with the I/O control boards (E0873) which are interconnected from customer to teller unit with a single CAT5 cable.

HA45 style customer units will have 5001 serial number and higher while all HA50 units with the control board mounted on the side are affected.

HA45 / HA50 Control Board Cover Panel Installation

The units were shipped with a clear plastic shield screwed to the frame of the customer unit above the control board. The frame has oval shaped wire openings in the horizontal frame plate above the control board which can allow water to drip through and onto the control board.

A few steps should be taken to help protect the control board from penetrating water inside the HA45 and HA50 customer units and to divert any water that does enter away from the control board.

Step 1) Remove the flat style clear plastic electrical panel cover and replace with the new style formed cover. Note the new cover does not use the old covers mounting screws but mounts to the top screw holding the electronic panel to the frame.

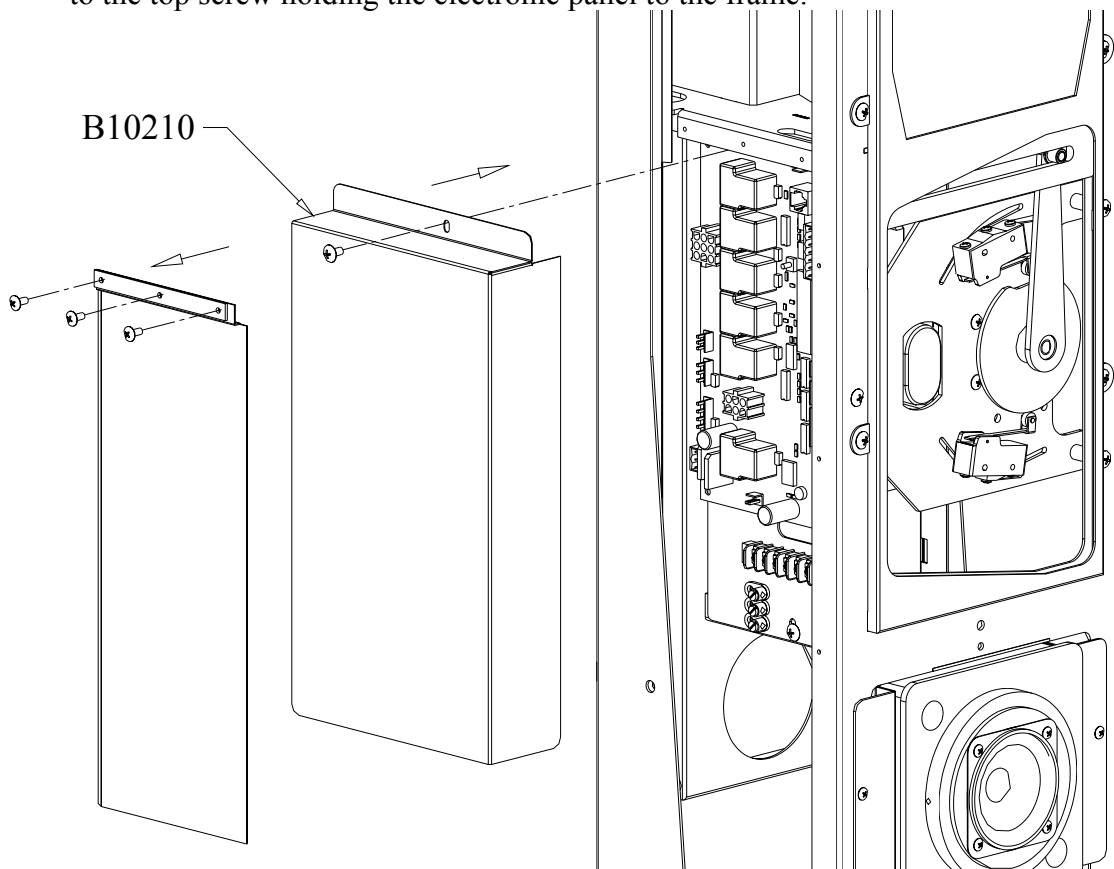

Step 2) Cover and seal oval shaped wire openings in frame above control board. Cut plastic from old style flat cover removed in step one to glue and seal over openings. Seal along back and side of this frame panel also to stop any water from running down onto the control board below.

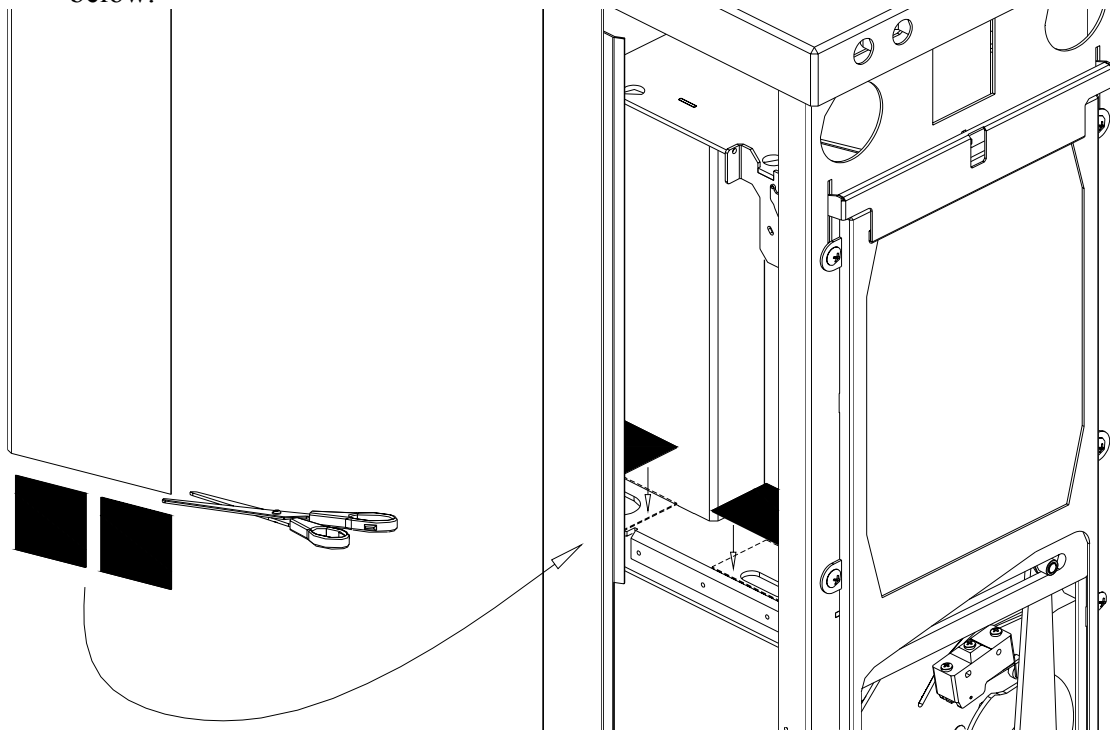

Seal rear corner of frame to prevent water penetration. Cover and seal both oval shaped wire openings.

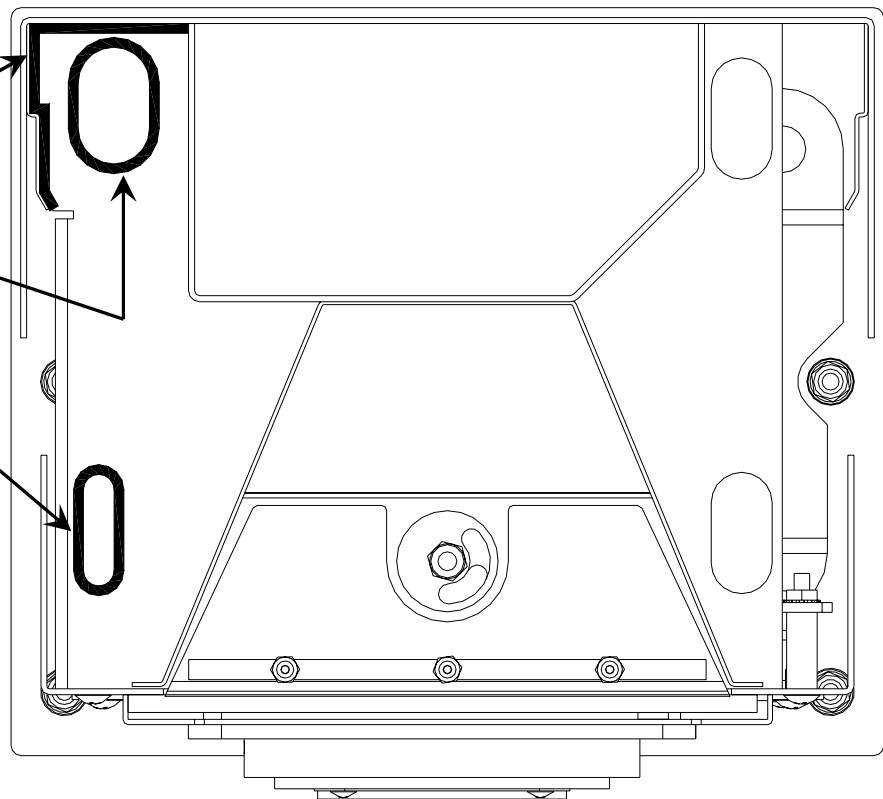

- Step 3) Seal top cover conduit caps or conduit fittings to prevent water penetration though top cover.

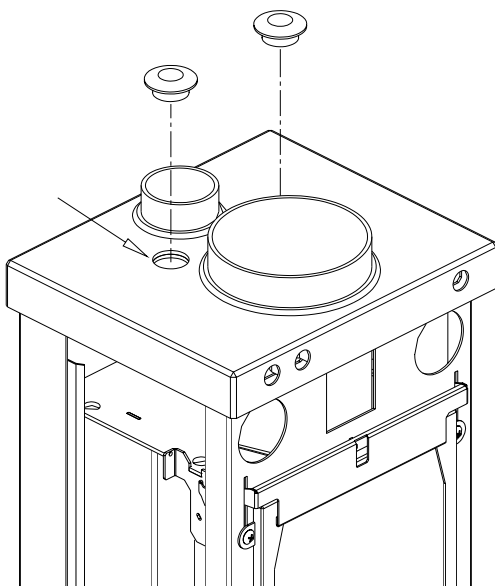

- Step 4) Install main power switch cover between switch and control panel. This is not for water protection but added safety protection for service personnel. Remove screws mounting power switch to electronic panel. Insert new switch cover between electronic panel and switch as shown. Reinstall switch to the electronic panel. The cover should cover the front side of the switch where the power wires are connected.

