

HAMILTON

B6833 VENTILATOR ASSEMBLY

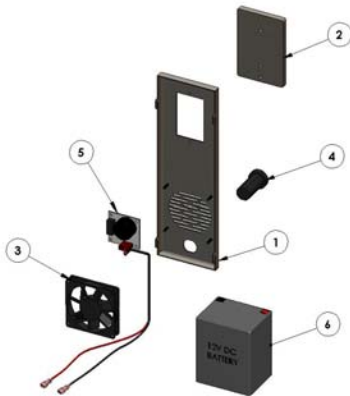

1. B6833-A VENTILATOR FACE PLATE
2. E0944 PHONE JACK
3. E0941 12V DC FAN
4. E0943 PUSH BUTTON SWITCH
5. E0964 REV A TIMER/
LOW BATTERY
ALARM
6. E0940 12V DC BATTERY
7. H3704 BLANK SWITCH COVERS
(NOT SHOWN) (FOR USE IF
LIGHT AND PHONE ARE
NOT USED)

INSTALLATION INSTRUCTIONS

1. Carefully place (E0940) Battery through opening in back of frame Stainless Steel and rest battery on shelf inside. Attach wires from harness with female blade connectors to battery. (Red wire to (+) Red Terminal of battery) Black Wire to (-) Black Terminal of Battery)

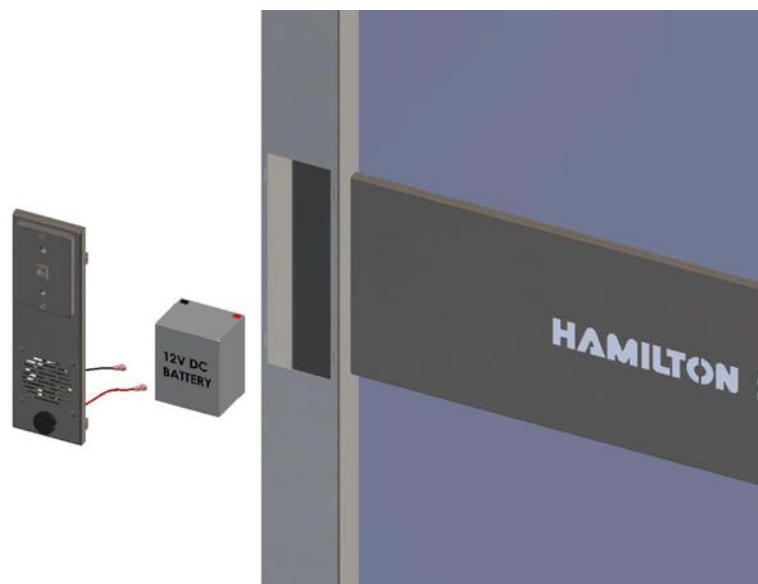

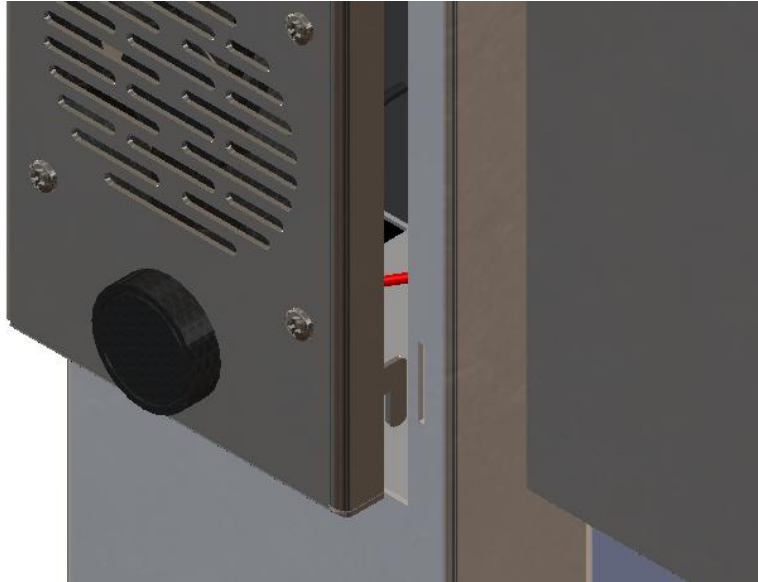

2. Align Tabs of Ventilator Face to Slots in Frame Stainless Steel. Insert into slots then carefully slide Ventilator Face downward until it bottoms out in slot of Frame Stainless Steel.

E0941 FAN INFORMATION

80x80x25mm (3.15"x1.0") DC FAN - 3300 RPM - 40 MAX. CFM - 33 NOISE (dB)

12VDC - 7~17 VOLT RANGE - .18 AMPS - .23 MAX STATIC PRESSURE INCHES

E0964 REV A TIMER/LOW BATTERY ALARM INFORMATION

Description of Operation

- Battery OK (> 10.2 Volts) – Pressing the button will start the fan and the fan will run for 3 minutes and automatically shut-off.
- Low Battery Warning (9.5 to 10.2 Volts) – In this mode pressing the button is the same as battery OK mode except there will be a single beep at the start of the fan and a single beep at the end of the 3 minutes. This mode warns the user that the battery is getting low.

Operation Note: If at the button press the voltage is greater then 9.5V and while the fan is running it drops below 9.5V (into the exhausted state) then the beeper will beep twice (one short beep followed by one long beep) to make this indication. At this point replace or recharge battery.

- Battery Exhausted (<9.5 Volts) – In this mode pressing the button WILL NOT run the fan and the beeper will beep twice; one short beep followed by one long beep. At this point replace or recharge the battery.