

Hamilton Safe Company

98RH Nighthead

Instruction sheet for replacing Diebold 103 / Eagle 103 with Hamilton 98RH.

DOCUMENT NUMBER 08-326

Diebold/Eagle 103



Hamilton 98Rh



Hamilton Safe Company

Tools required: Hex wrench set, cold chisel, hammer, saws-all w/5" & 12" blade(cutting torch optional), screwdrivers, 5/16" drill, 3/8-16 tap, grinder.

Step #1: With the hopper in the open position, use a hex wrench or screwdriver to remove seven flathead screws from the face of the Diebold/Eagle head, located behind the hopper door.



Step #2: Now the entire face and bucket can be removed with the hopper in the open position.



Hamilton Safe Company

Step #3: Remove the four screws holding the gate guide track with hex wrench and remove gate guide track.

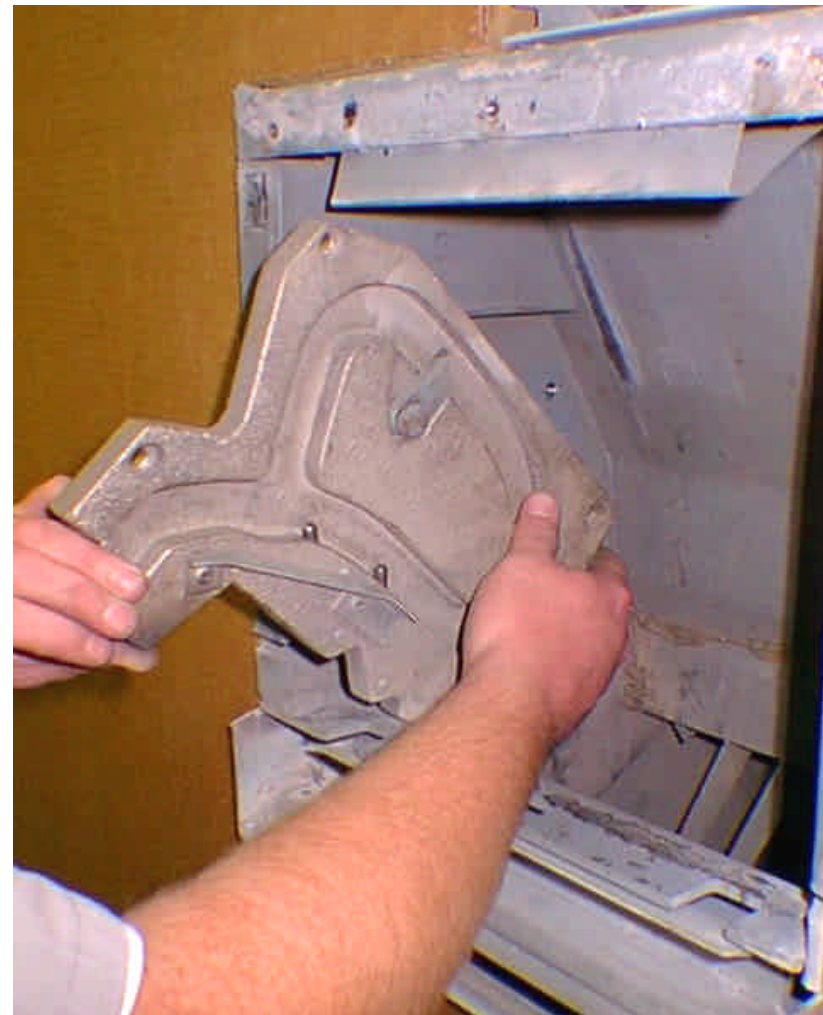

Step #4: Break the welds holding the front of the curved plate at the top of housing with a cold chisel and hammer. Bend the plate down to break the welds in the rear and remove the plate.



Hamilton Safe Company

Step #5: Break the welds holding the plate on the upper left side of the housing with the chisel and hammer and remove plate.

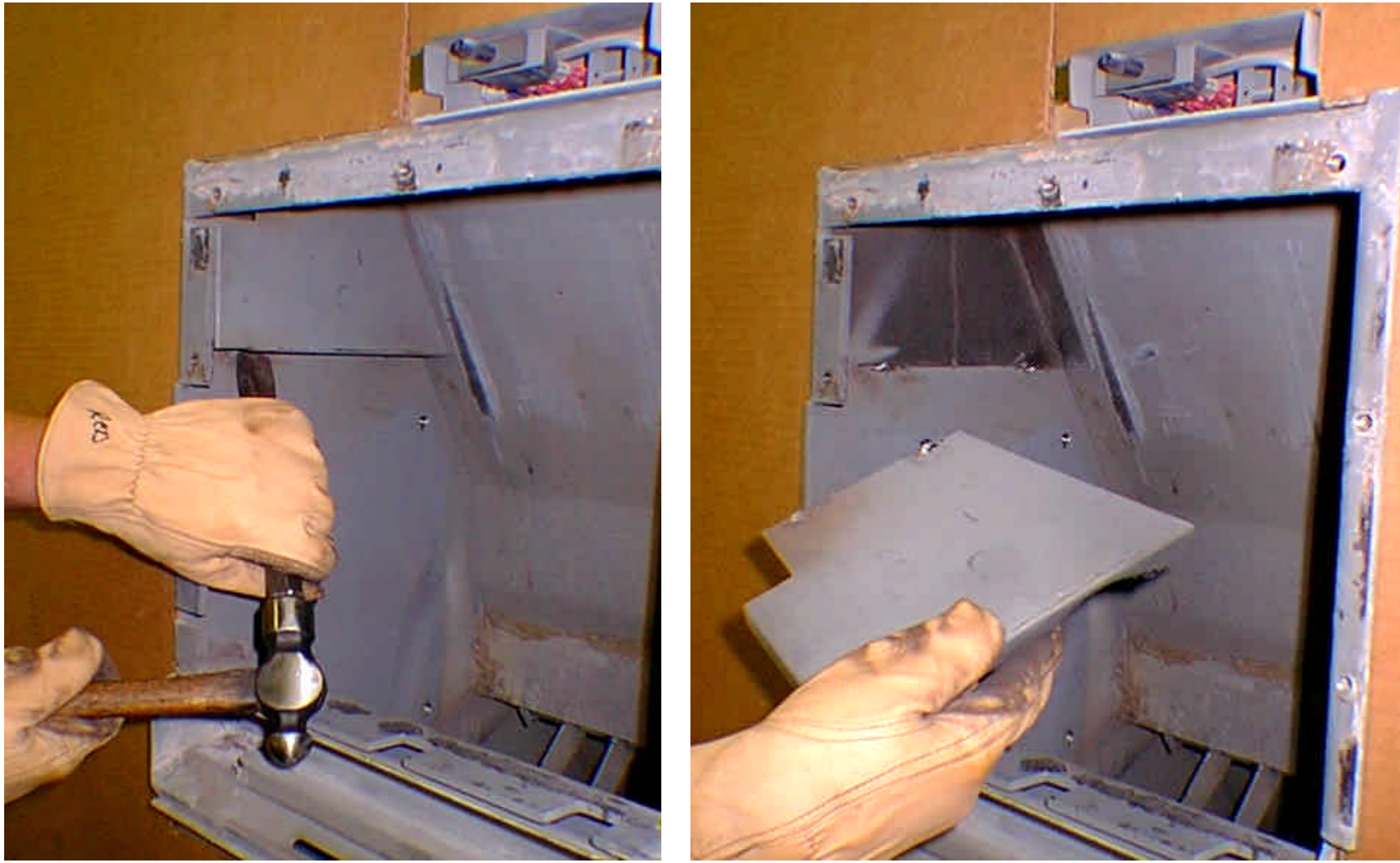

Step #6: Using a saws-all, cut and remove the metal on the left side and top of the housing so they are flush with the inside wall and inside top of the housing.



Hamilton Safe Company

Step #7: Cut out to both sides of the housing, flush with the bottom of the envelope slot. Then cut down both inside edges of the housing to the cut from the envelope slot and then rotate the saw down to cut the rest of the lower housing out and remove.



Step #8: With your saws-all or grinder, remove the lower side tabs from the envelope area so they are flush with the wall.



Hamilton Safe Company

Step #9: Using grinder, make all the edges flush with the wall face and the inside of the housing to make the opening 13-1/2" minimum width and 15-3/4" minimum height.

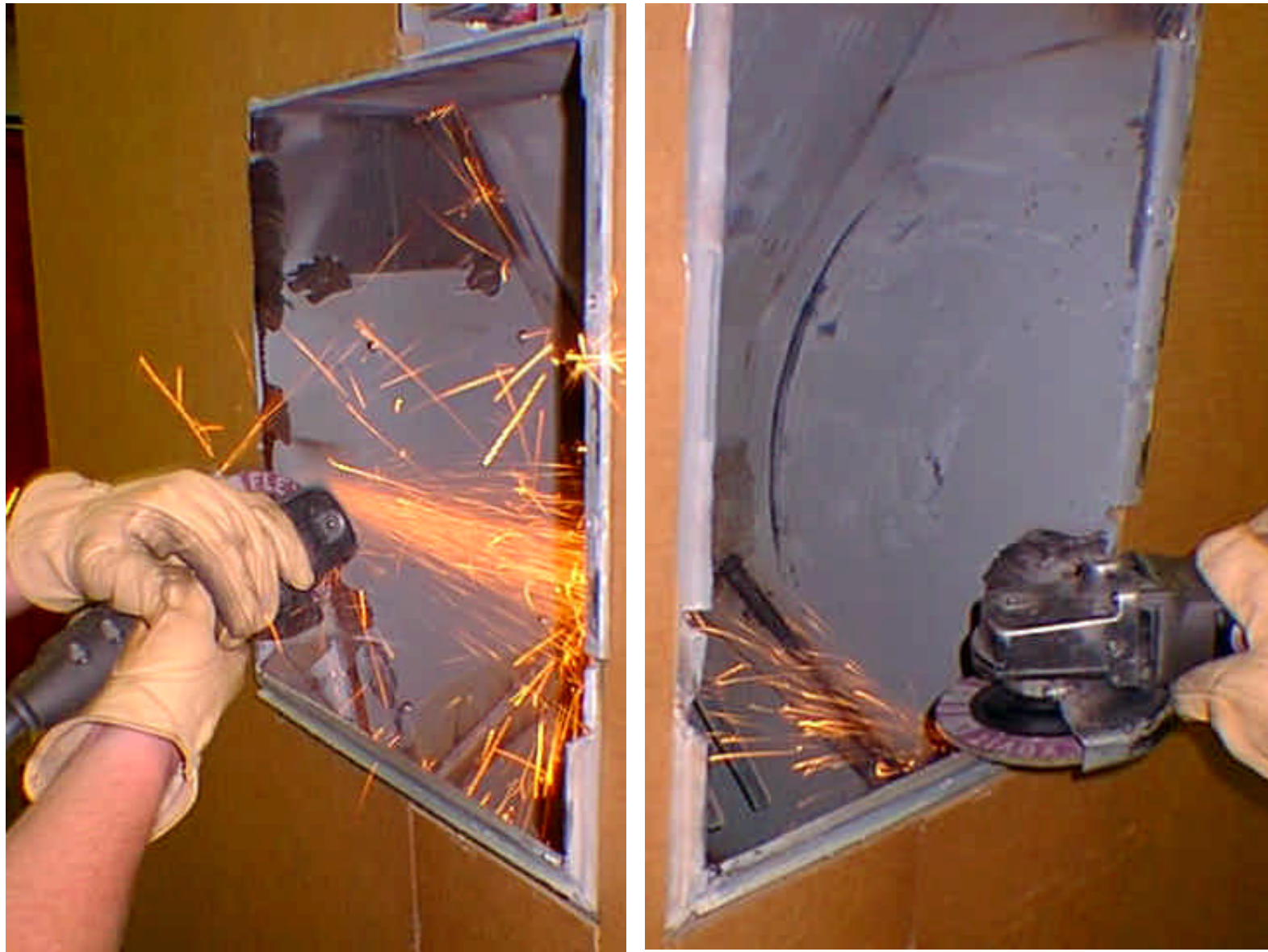

Step #10: If your template is not yet formed, bend both sides up 90 degrees and bend both tabs on the top of each side down 90 degrees.

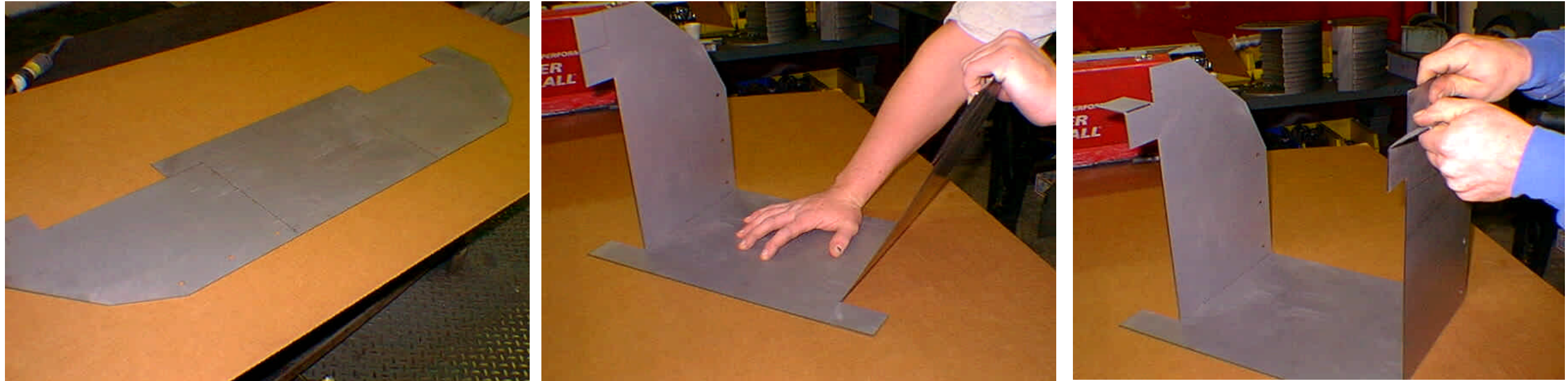

Step #11: Place the template into the housing making sure the four tabs are flush with the wall face. Drill the six holes with a 5/16" drill. The holes need to be tapped 3/8-16.

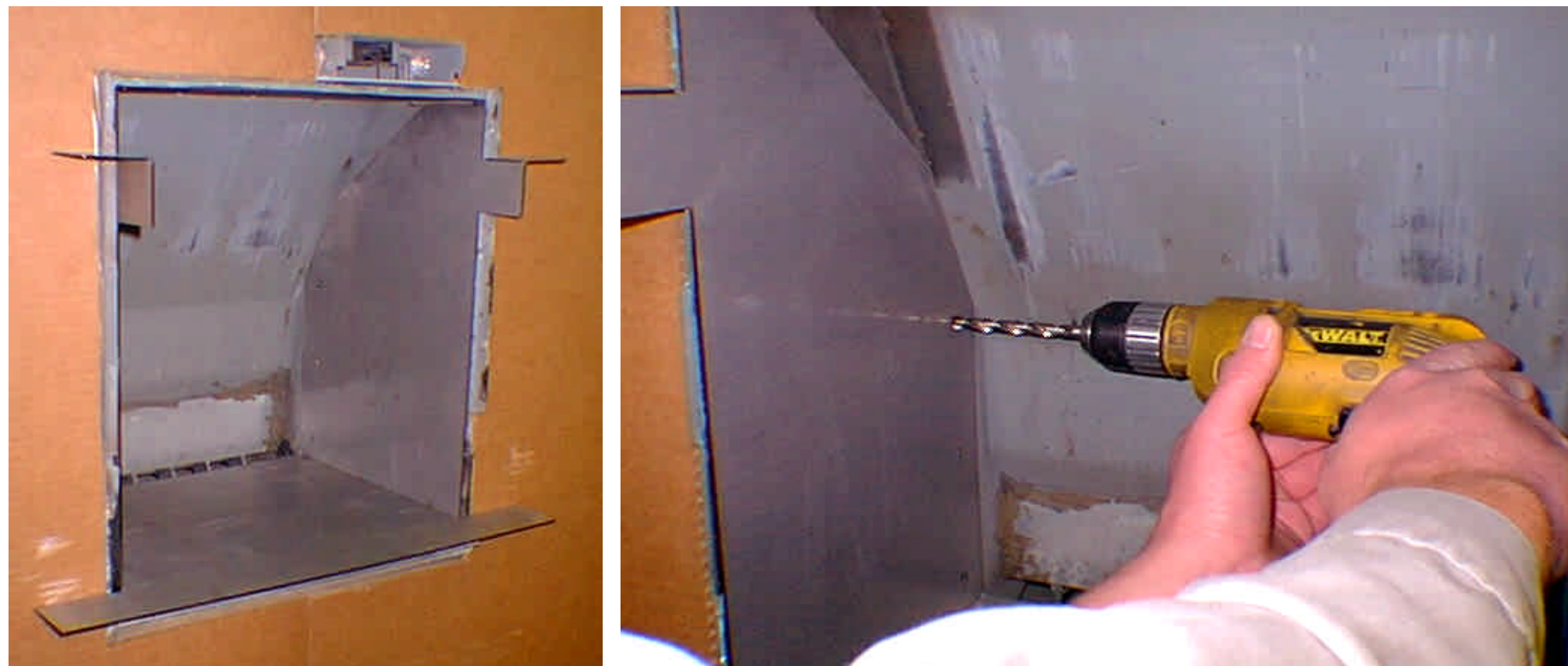

Hamilton Safe Company

Step #12: Set the new 98RH Nighthead in the housing and partially open the bucket to allow the head to be pushed into the housing flush with the wall face.



Step #13: From inside the safe bolt the new head into place using six 3/18-16 bolts with lock washers and flat washers.

